





Quotation

Dia: 19mm

LAS1-AGQ Series (CE RoHS)

Switch Rating: 5A/250V

Photo	ONPOW Code	Function	Contact Strucrue	Best Price (IP65)
	LAS1-AGQ-11	Momentary	1NO1NC	USD 4.06
	LAS1-AGQ-11Z	Latching		USD 4.76
	LAS1-AGQ-22	Momentary	2NO2NC	USD 4.90
	LAS1-AGQ-22Z	Latching		USD 5.61
	LAS1-AGQ-11E	Momentary	1NO1NC	USD 5.32
	LAS1-AGQ-11ZE	Latching		USD 6.03
	LAS1-AGQ-22E	Momentary	2NO2NC	USD 6.17
	LAS1-AGQ-22ZE	Latching		USD 6.87
	LAS1-GQ-11E/L	Momentary	1NO1NC	USD 6.59
	LAS1-GQ-11ZE/L	Latching	1NO1NC	USD 7.29
	GQ22-11E	Momentary	1NO1NC	USD 6.31
	GQ22-11ZE	Latching		USD 7.01

Pin terminal

Screw Terminal

Pin terminal

Note: Price are same for different LED color and voltage.

Packing: 19mm - 40pcs / box 22mm - 20pcs / box

Gross weight LAS1-AGQ-11 - 0.79kg / 40pcs
 LAS1-AGQ-11E - 0.80kg / 40pcs
 LAS1-GQ-11E/L - 1.12kg / 40pcs
 GQ22-11E - 0.55kg / 20pcs

Delivery: EX-WORK

Payment: T/T in advance

Lead time: 1000pcs/15 workdays

All price in offer sheet are valid till end of July, 2012



- ⊙ Φ 19mm Diameter
- ⊙ Switch Rating: 5A/250VAC
- ⊙ Contact Configuration: 1NO1NC/2NO2NC
- ⊙ Operation Type: Momentary/Latching
- ⊙ The Crust Material: Stainless Steel
- ⊙ IP Degree: Ip67, IK09

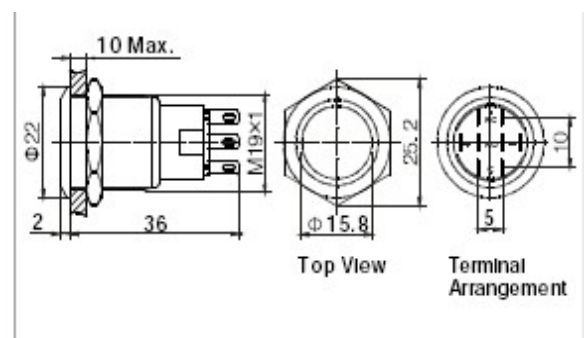

Metal ring illuminated push button



- ⊙ Φ 19mm Diameter
- ⊙ Switch Rating: 5A/250VAC
- ⊙ Contact Configuration: 1NO1NC/2NO2NC
- ⊙ Operation Type: Momentary/Latching
- ⊙ The Crust Material: Stainless Steel
- ⊙ Ring Illuminated
- ⊙ IP Degree: IP67, IK08

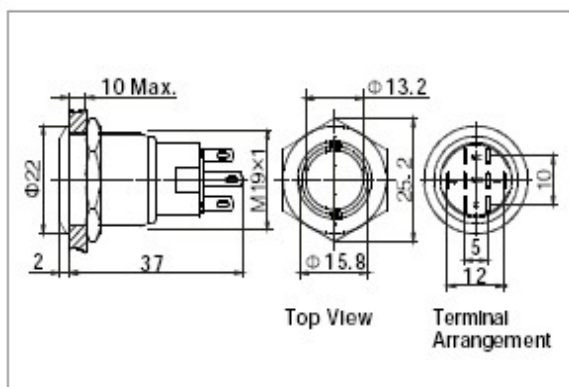

Anti-vandal ring illuminated push button



- ⊙ Φ 19mm Diameter
- ⊙ Switch Rating: 5A/250VAC
- ⊙ Contact Configuration: 1NO1NC
- ⊙ Operation Type: Momentary/Latching
- ⊙ The Crust Material: Stainless Steel
- ⊙ Ring Illuminated
- ⊙ IP Degree: IP65(IP67 Made to order), IK09

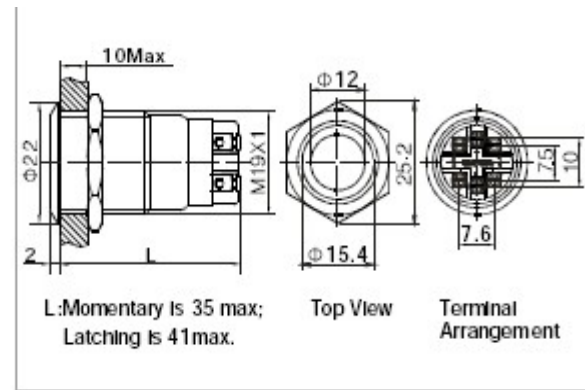

Anti-vandal ring illuminated push button



- ⊙ Φ 22mm Diameter
- ⊙ Switch Rating: 5A/250VAC
- ⊙ Contact Configuration: 1NO1NC
- ⊙ Operation Type: Momentary/Latching
- ⊙ The Crust Material: Stainless Steel
- ⊙ Ring Illuminated
- ⊙ IP Degree: IP65, IK10

